



## CARETTA CASSETTE FOLDING ARM AWNING

Architect designed, precision engineering – the result is a higher wind rating, maximum coverage and continuous weather protection.

- ▶ Architecturally designed full cassette ensures the fabric and components are completely protected from sun, humidity and poor weather conditions while providing a clean and minimal appearance when the system is retracted.
- ▶ Maximum lateral stability is achieved due to the patented Supa-Kombi arm assembly system which ensures unparalleled fabric tension is maintained in all positions.
- ▶ The unique design allows for up to 14000mm coverage in width and 4000mm in projection making the Caretta ideal for covering large areas.
- ▶ Our textiles offer the very best compromise between visibility and light transmission while providing incomparable weather resistance and ease of maintenance.
- ▶ Designed, engineered and manufactured in Germany. Certified ISO 9001: Safety tested by German TUV (Product Service).  MADE IN GERMANY



# CARETTA CASSETTE FOLDING ARM AWNING SPECIFICATIONS

Please note illustrations are not to scale. All measurements are in millimetres. Please contact your Viva Sunscreens representative for additional information.

## FIXING METHODS

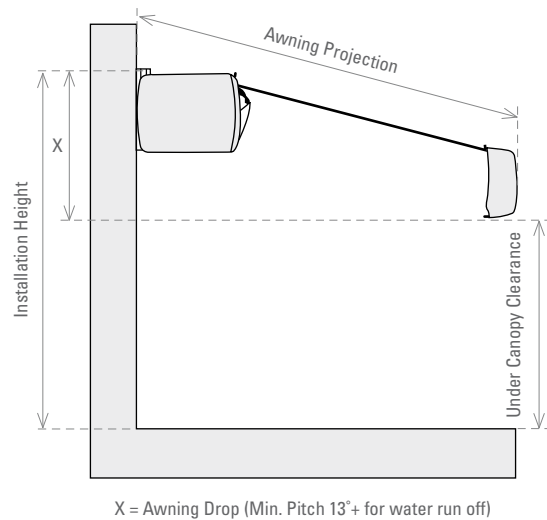
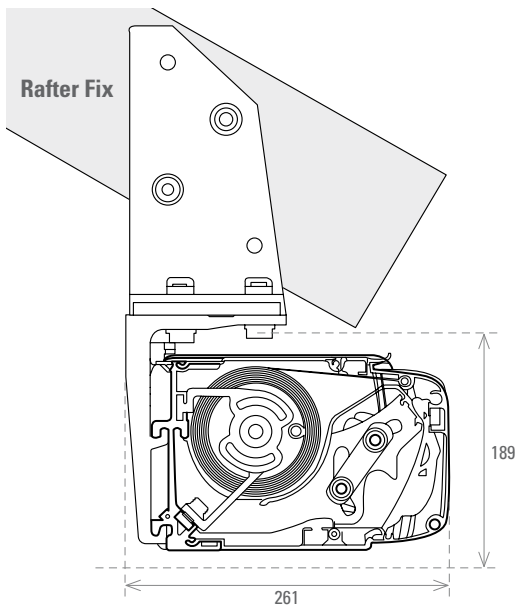
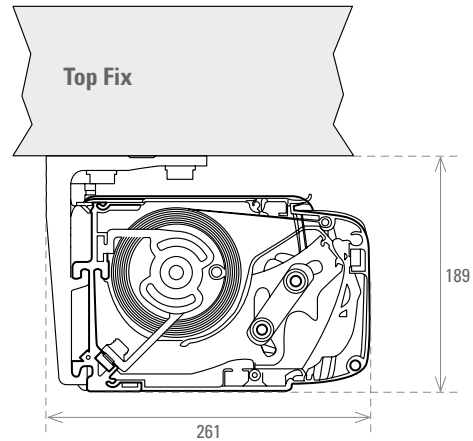
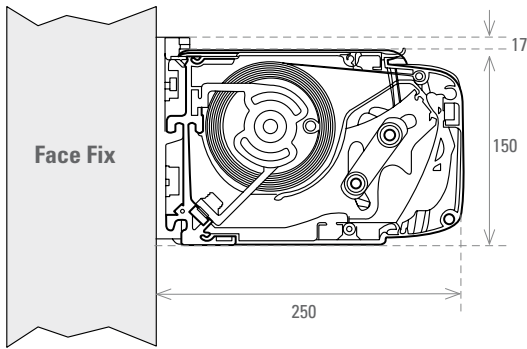

## AVAILABLE SIZES

WIDTH	Max. 12000mm (over 7000mm coupled fabric applies) / Min. 2000mm
PROJECTION	Max. 4000mm / Min. 1500mm

## HEADBOX

MATERIAL	Powder coated 6061 grade extruded aluminium
DIMENSION	Height: 167mm top/bottom, Depth: 250mm front/back
FINISH	Four standard colours and 300 colours available in the European RAL Powder Coat Range

## TOP ROLLER

MATERIAL	80mm diameter heavy duty extruded aluminium
----------	---

## ARM ASSEMBLY

MATERIAL	Powder coated 6061 grade extruded aluminium with 4mm wall thickness.
INTERNAL SPRING ASSEMBLY	Heavy duty 8 gauge tensile steel dual spring assembly with dual 3mm PVC coated 316 stainless steel cable providing unparalleled fabric tension

## END CAPS

MATERIAL	Powder coated cast aluminium providing a minimal profile appearance ideal for reveal installations
----------	--

## FIXING METHODS

TYPE	Concealed mounting brackets for face fixing, top fix and rafter brackets are also available
------	---

## CONTROL OPTIONS

CRANK OPERATION	Cast aluminium, 5.1 ratio, Gear 130X with extruded aluminium crank mechanism
ELECTRIC MOTOR	Tubular motor mounted internally within top roller. Aluminium case complete with built-in limit switches. Extensive range of control options available

## FABRIC OPTIONS

MARINE GRADE ACRYLIC	100% dope dyed acrylic "Sunacrylic" fibre - Orchestra, Symphony, Opera ranges are available
SUNSCREEN MESH	High tenacity polyester core yarn sunscreen - Oxygen S5 (5% openness) S15 (%15 openness) ranges

## STANDARD COLOUR OPTIONS OR CUSTOM COLOUR ON REQUEST

White/RAL 9016	Light Grey/RAL 7038	Light Ivory/RAL 1015	Grey Brown/RAL 8019
----------------	---------------------	----------------------	---------------------

P 1300 78 28 78

E products@vivascreens.com

**Sydney Awning Centre:**

1/6 Herbert Street, St. Leonards, NSW 2065

**Melbourne Awning Centre:**

393 Swan Street, Richmond, Victoria 3121